

Top Bend Digital Pixel Single Color LED Neon Flex (13X12mm)

Features and Specifications



KEY HIGHLIGHTS

The LED Flexible Neon Strip is a high-performance linear lighting solution designed to deliver uniform, dot-free illumination with the visual effect of traditional neon light.

Added with a digitally addressable feature which allows individual control of each LED pixel by a SPI controller. Utilizing advanced encapsulation technology and a high-density LED strip, it provides smooth, continuous light output with excellent brightness consistency.

Constructed with a durable, UV-resistant and IP65-rated silicone housing, the strip is suitable for indoor and outdoor applications.

Its flexible structure with top bend feature allows for curved and creative installations.

Customizable lengths and cuttable sections ensure ease of installation.

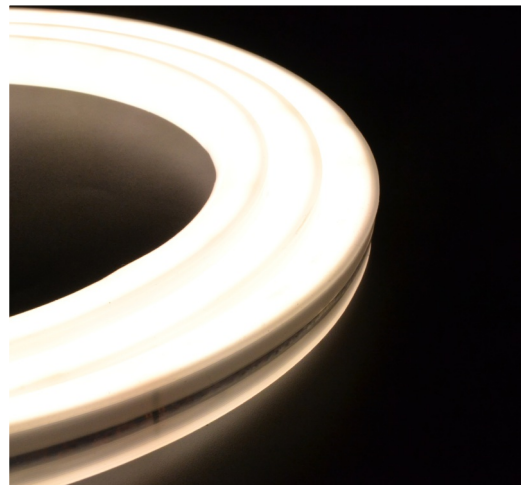

TECHNICAL SPECIFICATIONS

Input Voltage:	24V DC
Color:	1800K/2400K/2700K/3000K/4000K/6500K/Red/Green/Blue
Control Mode:	SPI
Bending Direction:	Top Bend
Reel Length:	5 Meters (16.4')
Lead Wire:	.15m to 2.5m customizable (3-Line)
IP Rating:	IP65 (Waterproof/Outdoor Rated)
Material:	UV-Resistant Silicone
Wattage:	12W/m (3.6W/ft)
Dimmable:	Yes
CRI:	90+
Cutting Unit:	125mm
Dimensions:	13mm x 12mm (W x H)
Luminous Flux/m:	600lm



FEATURES

- ETL, CE, RoHS, CCC certified.
- CA Title 24: Compliant with approved drivers; consult factory for details.
- Operating Temperature: -20°C to 50°C (-4°F to 122°F)
- Storage Space Ready: Complies with NEC (NFPA 70) 410.16 requirements for closet installations.

WARRANTY

- 5-year coverage guaranteed when utilized with luzumi led approved power supply.

Note: The Warranty Period begins on the date of original shipment from our factory, the warranty covers product only and does not cover any labor or incidental charges related to service or warranty. This Warranty applies only to the original purchasers or authorized distributors.

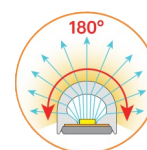
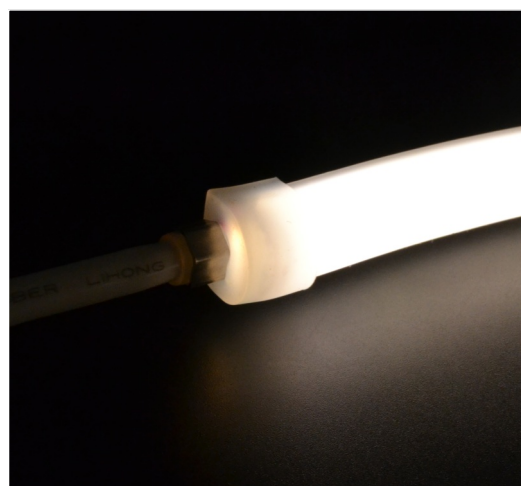

180° large beam angle

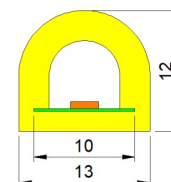

Top Bend Digital Pixel Single Color LED Neon Flex (13X12mm)

Features and Specifications



HOW TO ORDER A LUZUMI LED NEON TAPE LIGHT

Name	Wattage/m	Color	Control	Neon Dimensions	Bend Type	FPC Width(mm)	IP Rate	Voltage
FN	12W	W (18K, 27K, 30K, 40K, 65K)	SP	1312	T	10	A (IP65)	24
		R						
		G						
		B						



Example: FN12W-WSP1312-T10A24

MECHANICAL DIAGRAMS

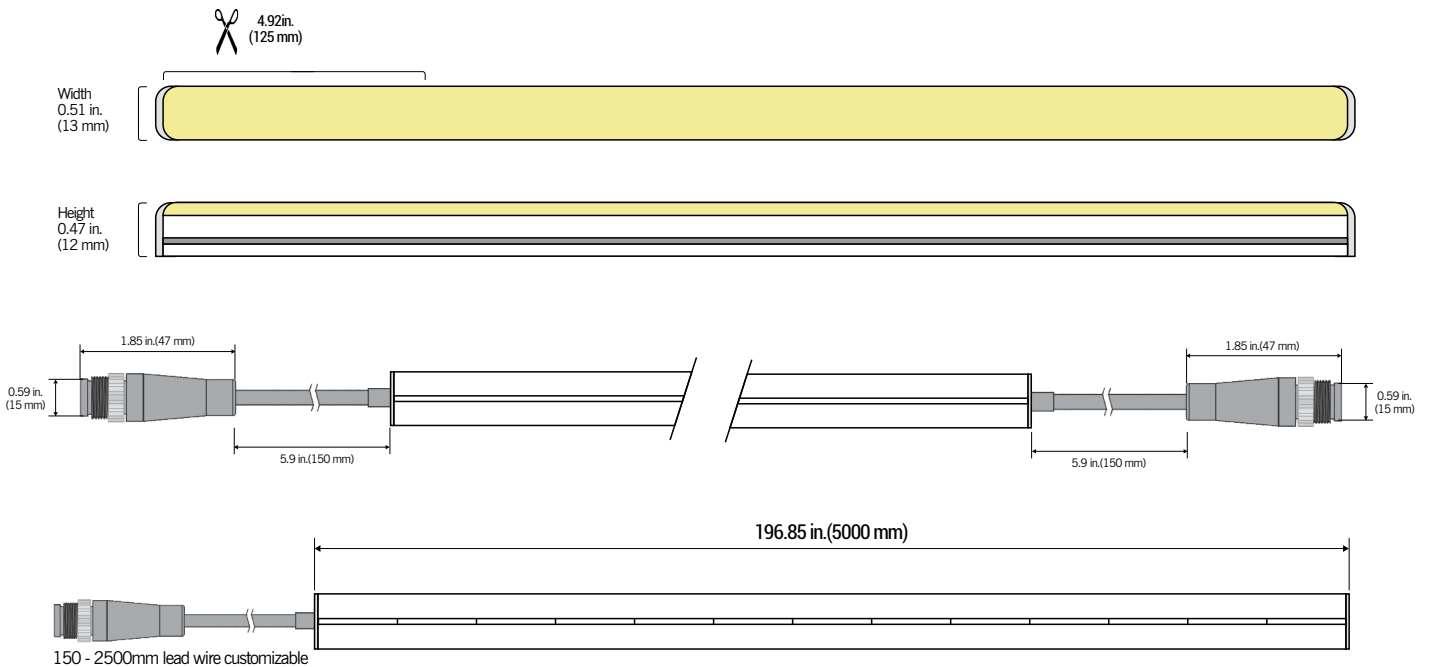

Lead Wire Options



Front Closed End

Top Bend

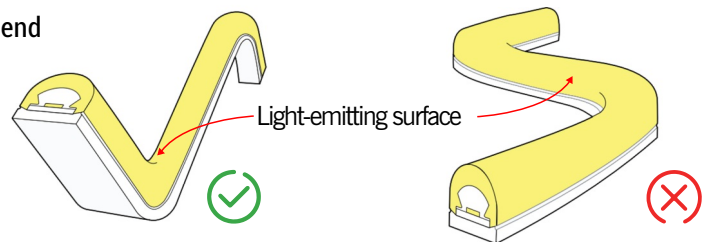

Use professional scissors to cut vertically at the cutting mark.

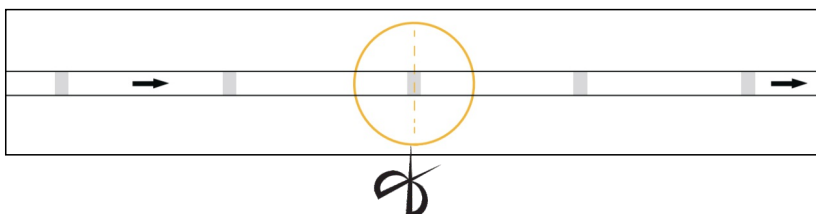

Top Bend Digital Pixel Single Color LED Neon Flex (13X12mm)

Features and Specifications



ACCESSORIES

Mounting Option (U Clip)

Secure the bottom U-clips to the surface using mounting screws at intervals of at least every 250mm. Once secured, press the Neon Strip firmly into the clips.

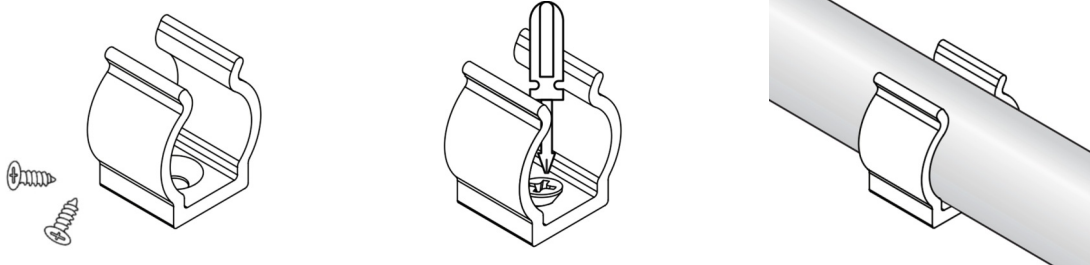

System Wiring Diagrams

The diagram below illustrates a standard system configuration. For larger installations or custom setups, please visit our website or contact technical support. Before beginning, consult the specific installation guides for each component to ensure you have the most current wiring instructions. All installations must comply with national and local electrical codes. Note that wiring configurations may vary depending on your specific power and dimming requirements.

Single Color SPI System Diagram

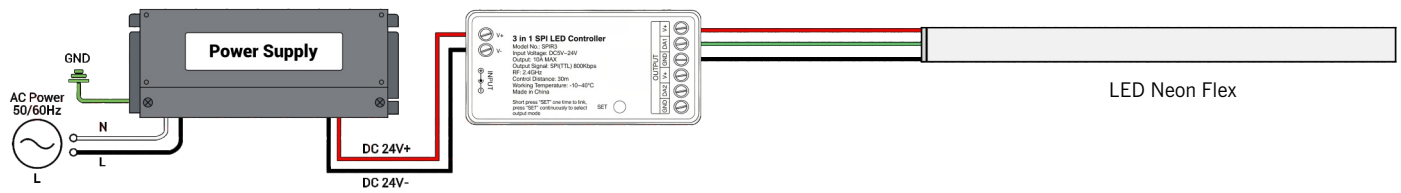

Common Controller for LED Neon and Tape Light

3 in 1 SPI LED Controller (2.4GHz)

- SPI signal transmission, 2.4G wireless remote control within 30m
- Support multi types IC of digital led strip like single color/RGB/RGBW
- Control speed, brightness, direction with various dynamic mode, save 4 scene
- Animation performance while turn on or off lights
- Set up different color sorting
- It can control the number of pixel point

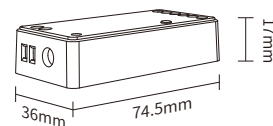

SPIR3
3 in 1 SPI LED Controller (2.4GHz)
Output: Max 10A

Model No.	Output Mode	Input Voltage	Output Signal	Pixel	Working Temp.	Control Signal	Control Distance
SPIR3	3 in 1	DC5V~24V	SPI (TTL) 800Kbps	Single color: 2048	-10~40°C	2.4G RF + PUSH	2.4G RF: 30m

Top Bend Digital Pixel Single Color LED Neon Flex (13X12mm)

Features and Specifications



Power Supplies for LED Neon and Tape Light

Constant Voltage Metal Power Supply (Non-waterproof, IP20)



Model No.	AC input voltage range	Output
SL-V-12XXXM (SL-V-24XXXM)	100-240V	DC 12V or 24V, Max. Output Options: 15W,35W,50W,60W,70W,100W,120W,200W,250W,300W,350W,400W,500W,600W

Constant Voltage Metal Power Supply (Non-waterproof, IP20)



Model No.	AC input voltage range	Output
SL-V-12XXXPU (SL-V-24XXXPU)	90-264V	DC 12V or 24V, Max. Output Options: 12W,24W
SL-V-12XXXP (SL-V-24XXXP)	90-264V	DC 12V or 24V, Max. OutputOptions: 36W,48W,60W

Constant Voltage Power Supply (Waterproof, IP67)



Model No.	AC input voltage range	Output
SL-V-12XXXM (SL-V-24XXXM)	170-250V	DC12V or 24V, Max. Output Options Output : 10W, 20W, 30W, 45W, 60W, 100W, 150W, 200W